

Ora Top-Fixing C-Clamp

Installation Guide

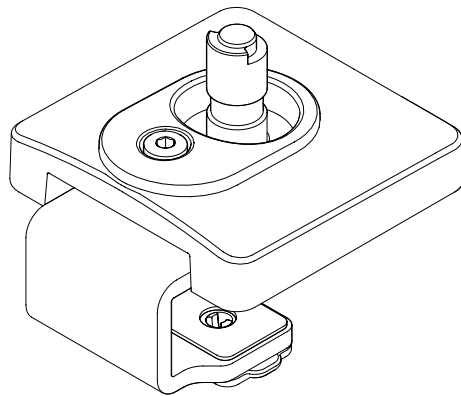

COMPONENT CHECKLIST

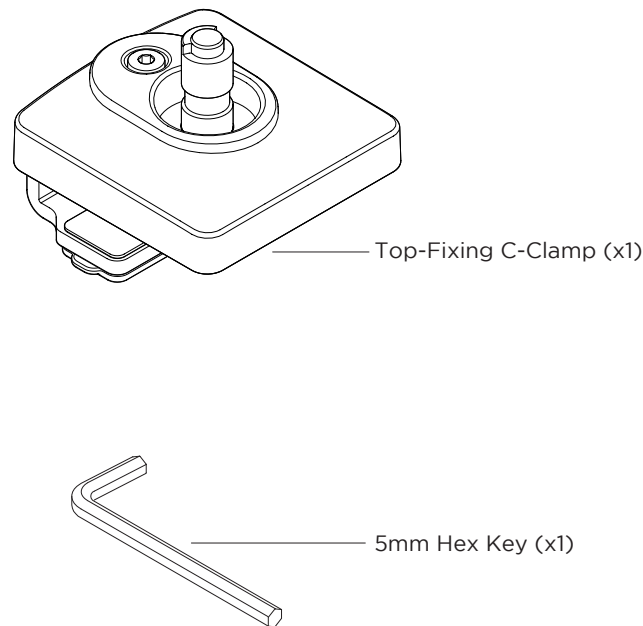

CAPACITY

Weight: 2 - 8kg (4.4 - 17.6lb)

Worksurface Thickness: 18 - 26mm ($\frac{1}{4}$ " - 1")

WARRANTY

10 Years Limited

TOOLS REQUIRED

All tools supplied

IMPORTANT INFORMATION

- Install Ora Top-Fixing C-Clamp as per these installation instructions.
- The manufacturer accepts no responsibility for incorrect installation.
- This product is compatible with Atdec AW-ORA monitor arms.
- This product is not suitable for outdoor use.
- Do not use this product for mobile applications.
- Please ensure desk structure and mounting surface are of sufficient strength to support this product and mounted equipment.
- Deep devices (such as all-in-one PCs), VESA mounted accessories (such as mini PC brackets and mounts), and offset VESA locations exert additional leverage that can exceed the capacity of the mount even though the monitor weight may be within the stated range. Please contact Atdec if you would like further information.
- Ensure the monitor is always positioned over the work surface. Do not position the monitor beyond the rear edge of the work surface.
- Product is not suitable for installation on work surfaces with a bullnose or bevelled edge.
- Periodic tightening of clamp screw may be required.

ATDEC

No portion of this document or any artwork contained herein should be reproduced in any way without the express written consent of Atdec Pty Ltd. Due to continuing product development, the manufacturer reserves the right to alter specifications without notice. ©20240902

1 Configure Clamp For Desk

1.1

Desk Thickness

21 - 26mm
($\frac{13}{16}$ - 1")

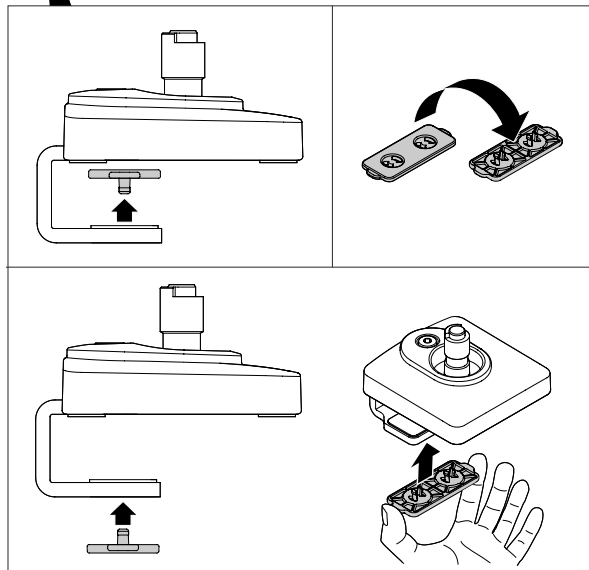
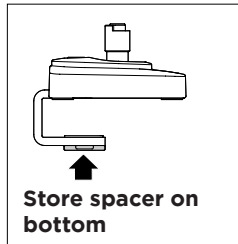

OR

Desk Thickness

18 - 21 mm
($\frac{11}{16}$ - $\frac{7}{8}$ ")

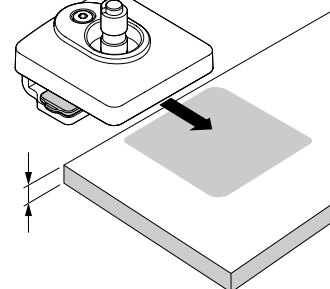
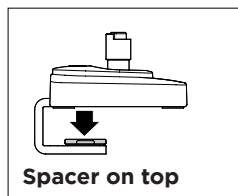

1.2

Using supplied 5mm Hex Key unscrew bracket until it can slide onto the edge of the work surface.

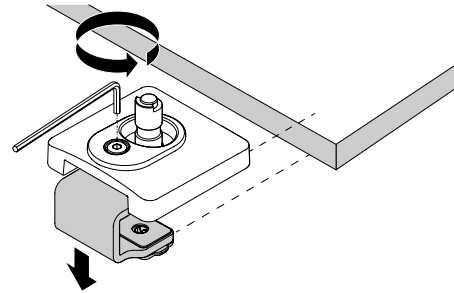

NOTE

If bracket is accidentally removed, reassemble as shown.

IMPORTANT

Clamp must never be attached without washer!

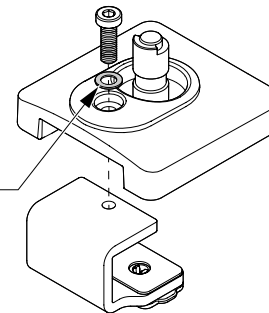

2 Attach Clamp to Desk

TIP!

When positioning the desk clamp, offset the clamp to the left or right of the seating position. The monitor will then be centred for the user.

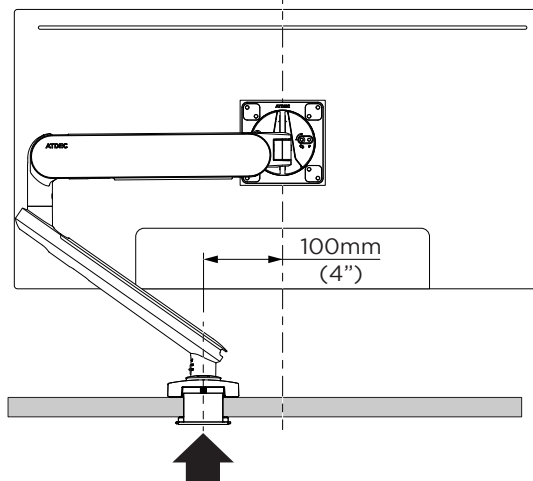

2.1

Slide clamp onto the edge of the worksurface.

TIP! Press down screw while sliding

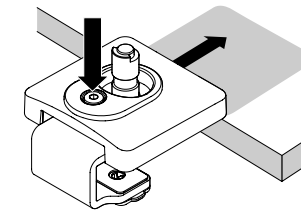

NOTE
Bevelled edges not compatible

IMPORTANT

Ensure clamp is pushed up against work surface edge

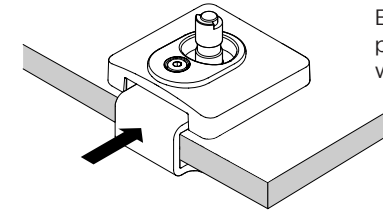

2.2

Hold clamp square to desk edge and tighten firmly with supplied 5mm Hex Key.

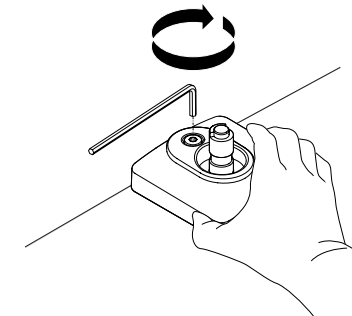

3 Install Ora Monitor Arm

3.1

Follow the installation guide provided with your Ora Monitor Arm to install it on the Top-Fixing C-Clamp.

