

Ora Top-Fixing C-Clamp

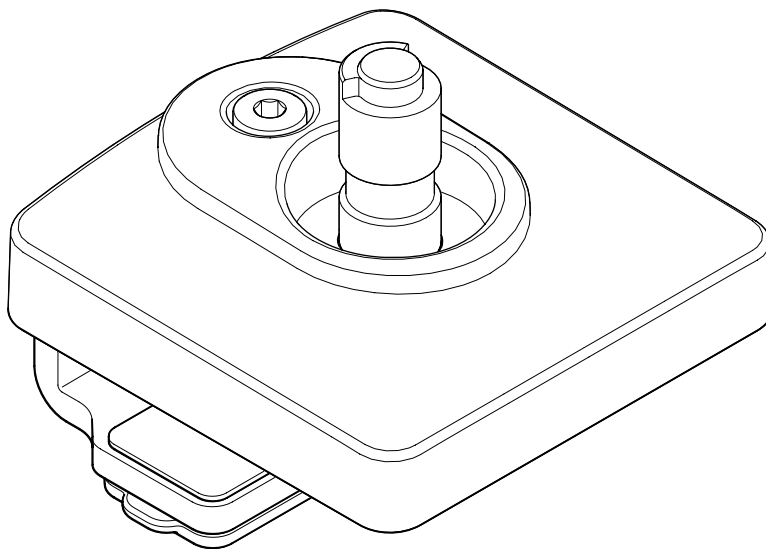

FEATURES

- Top fastening clamp for Ora monitor arm
- Single fastener for fast installation
- Slim under desk profile minimises impact on cable trays and cabinetry
- Premium painted metal base matches the styling of the arm

Display weight 2-8kg (4.4-17.6lb)*

Worksurface thickness 18-26mm (0.71-1")

Pan adjustment 180° / 360°

Primary materials Aluminium, Steel

* Deep devices (such as all-in-one PCs) and offset VESA locations exert additional leverage that can exceed the capacity of the mount even though the monitor weight may be within the stated range. Please contact Atdec if you would like further information.

WARRANTY

10 years limited

DIMENSIONS

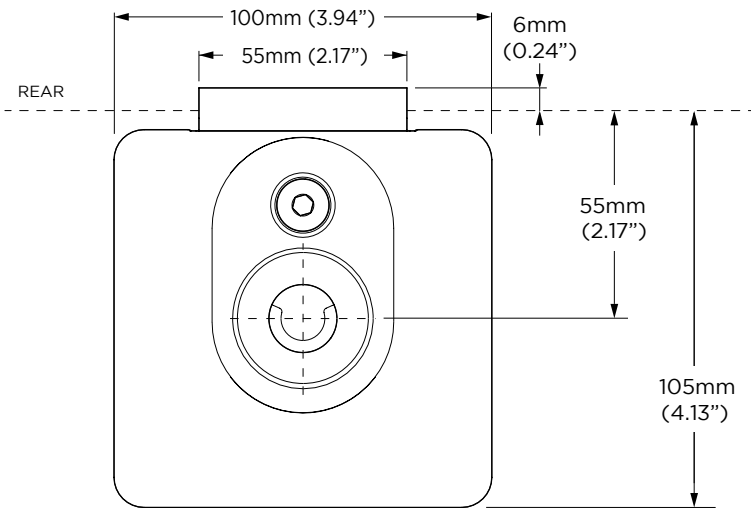

TOP VIEW

WITHOUT SPACER

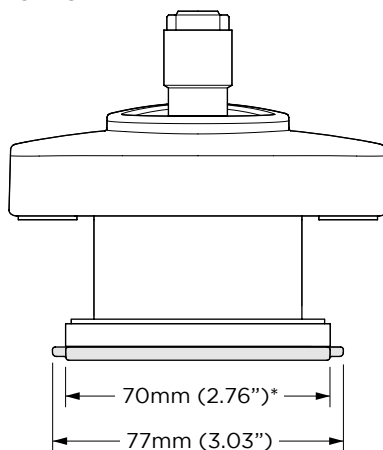

FRONT VIEW

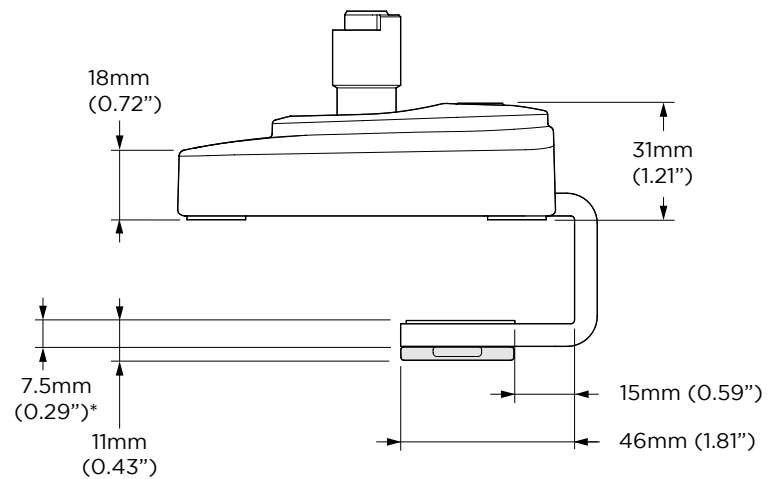

SIDE VIEW

* Spacer can be removed from underside of product to achieve this minimum under desk size

WITH SPACER

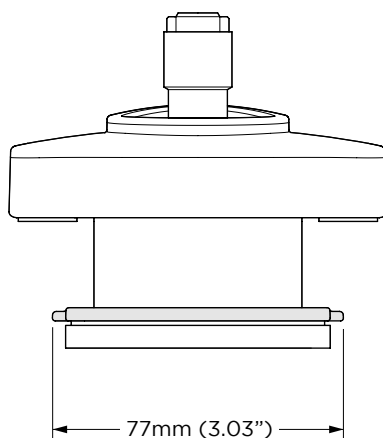

FRONT VIEW

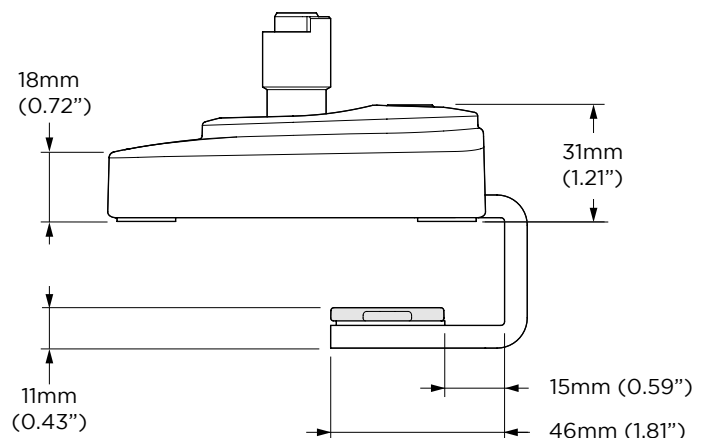

SIDE VIEW

DIMENSIONS | WORKSURFACE

WITHOUT SPACER

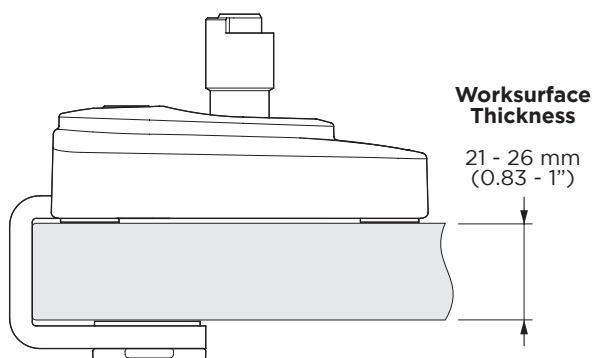

WITH SPACER

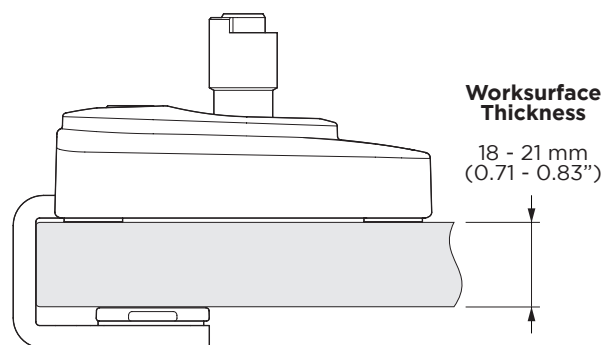

DIMENSIONS | ARM

